

ANDROID INSTRUCTIONS – SET UP OF LOCATION SERVICE

Location Services – These must be turned on for the program to work.

Turning on Location Services requires giving permission to **both** the **actual Camera** and **Android's Chrome, Camera, and Google Settings**.

A. Camera Permissions - There are differences from phone to phone - Open up your camera as if you were about to take a picture. Look at the top or bottom corners for ellipses (three circles), a cog wheel or a hexagon with a dot inside like those shown below.



Fig 1



Fig 2

Fig 1 (cogwheel – upper left corner) and Fig 2 (Ellipses upper right corner) above are examples of how the symbols appear on the screen. So you can find them with ease, each symbol here is circled in red and pointed to by a red arrow. The symbols are very small.

Touch whichever symbol you have and then look at the menu that appears. Locate the location setting. The location settings also vary depending on the phone. Typically (but not always), the setting is preceded by the map pointer icon (pictured at left). Names contain either the word **Location** (Location Info, Location Service, Store Location information, Save Location) or some version of **Geo** – (Geo tagging, Geo-tag, Geographic Locations) .



Activate the location data – that may be a slider (slide the ball all the way to the right), a radio button (touch it) or a crossed out icon – touch it to remove the cross out. You may also be given the option of when to allow location data to be provided – touch: **when using this application**.

Examples of what you might see are shown below in **Fig 3** thru **5**.

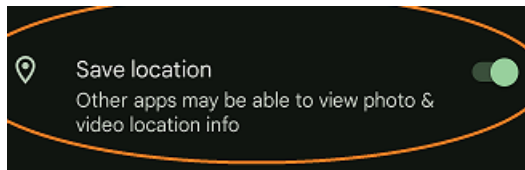

Fig 3 – “Save Location – slider ball to right

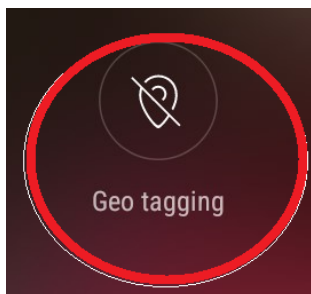

Fig 4a Geo tagging
crossed out (inactive)

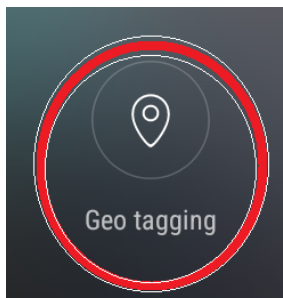

Fig 4b Geo tagging -
cross out removed
(Activated)

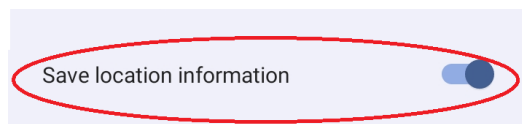

Fig 5 – Save Location
Information – slider ball right

Some phones have multiple menus – if you don’t see the map icon/Location/Geo descriptions, check to see if there is a **More settings** button and touch it. Google’s Pixel phones have this button. **Fig 6** below left provides the screen that you will see after you touch the Cog on a Google Android phone. **Fig 7** below right appears after **More Settings** is touched.

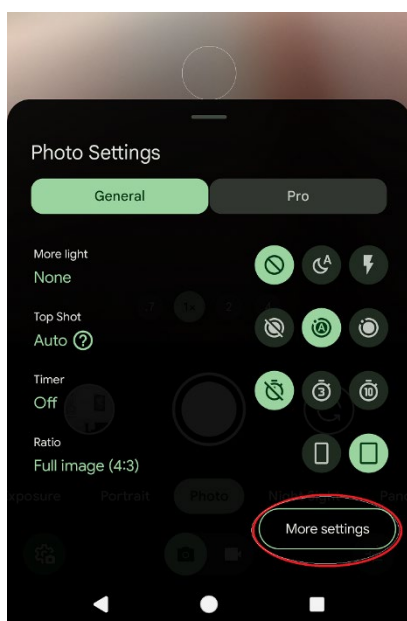

Fig 5

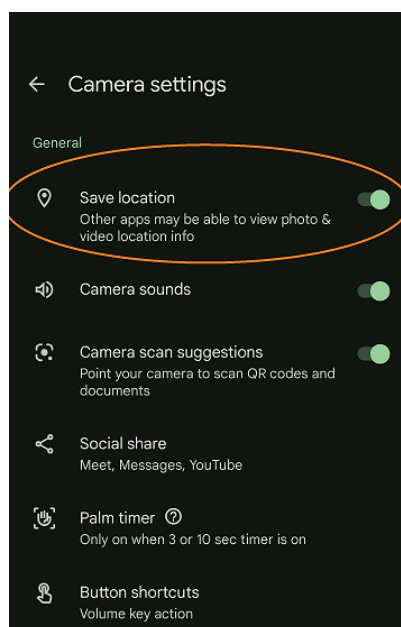

Fig 6

B. Android Settings – Chrome, Camera and Google

- 1) Touch the **Settings** Icon on your **home** screen (**Fig 1**) - the cog wheel - circled in black – below left) . Note – this icon may not appear on the first page of your home screen.

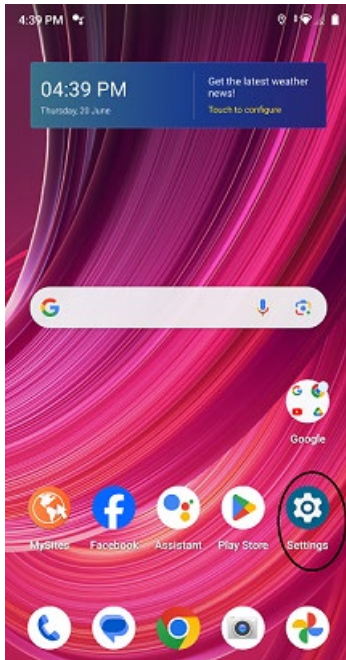

Fig 1

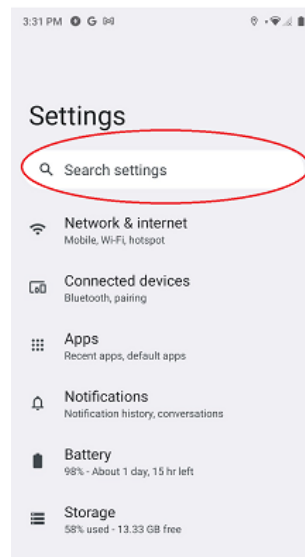

Fig 2a

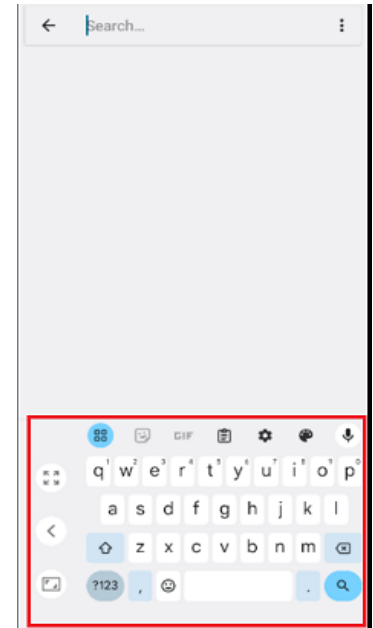

Fig 2b

- 2) **Fig 2a** – the **Settings** screen will appear (above middle). Touch Search settings (circled in red) and your virtual keyboard will appear –pictured above right in **Fig 2b** – the Virtual key board is highlighted with a red box. Key in **Loc**.

- 3) **Fig 3** will appear – below left. Touch the red circled **Location**. On some Androids, the **Location** bar has the map pointer Icon by it.
- 4) **Fig 4** the **Location screen** will appear – below middle. **Use Location** needs to be on. If not on, touch and slide the circle to the right as shown in **Fig 5** below right(circled in red).

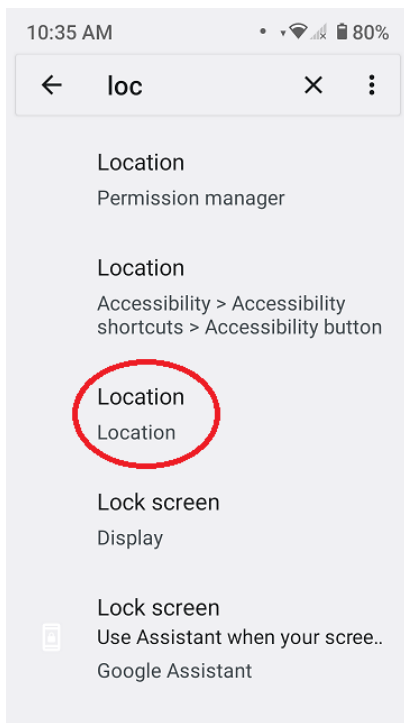

Fig 3

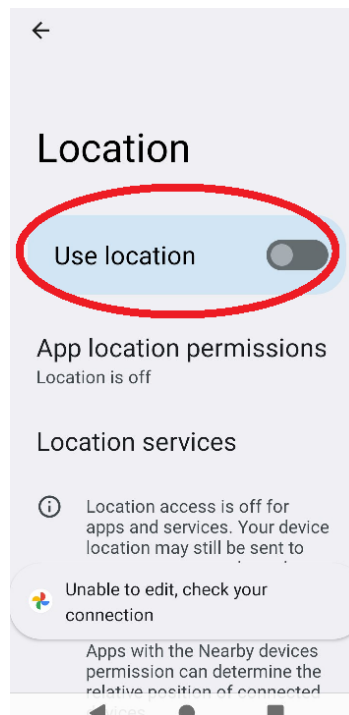

Fig 4

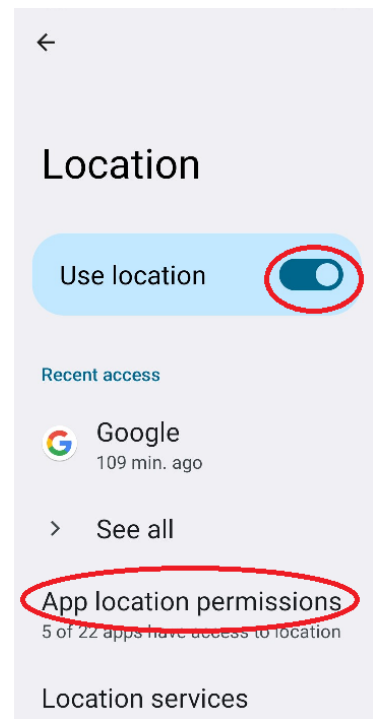

Fig 5

- 5) Next you will need to give your Chrome Browser, Camera, and Google permission to access your precise location. Touch **App Location Permissions** (circled in red on **Fig 5, above right**). **Note:**Android phone naming varies from model to model but should contain the word “permissions.” Skip this step on the Google Pixel as the permissions are in the **Location** screen.
- 6) There are three permission classes in **Fig 6** (below left) – **Allowed all the time** [Note: Google **Must** be in this category – it is a factory setting]; **Allowed only while in use**, and **Not Allowed**. Blue boxes are around each category. Look for **Chrome** in either the **Allowed When in Use** (default factory setting) or **Not Allowed**. Here It is **in the Allowed only while In use**. Touch **Chrome** (there is a red circle around it) to verify that **Use Precise Location** is authorized.

7) **Fig 7** – The **Location permission Chrome** screen will appear (below, middle). Note: **Use Precise locations** is off. Touch the gray circle and slide it to the right (there is a red circle around it).

8) In **Fig 8** (below right), **Use Precise Location** is now active – the gray circle is light blue and all the way right. The active permission is “**Allow only while using the App.**” “**Ask every time** is also ok.”

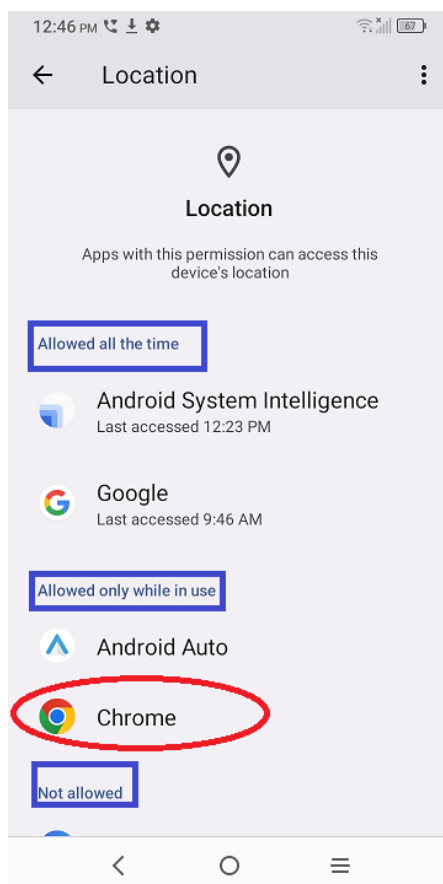

Fig 6

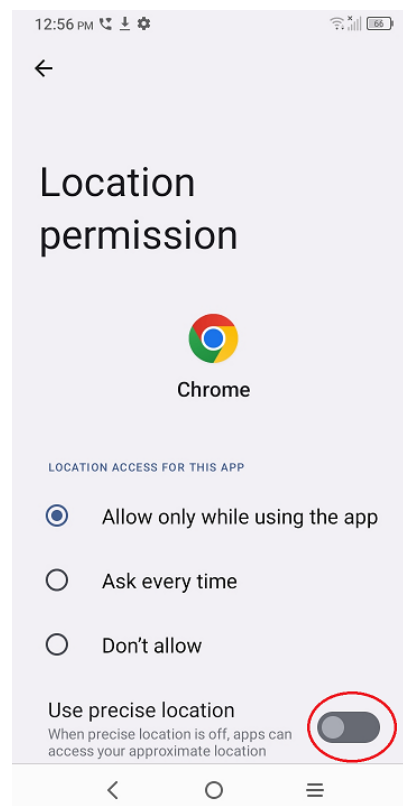

Fig 7

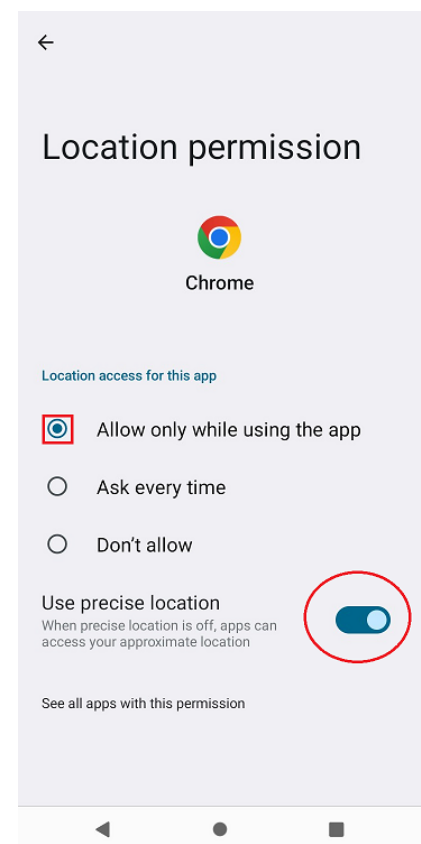

Fig 8

Now repeat these steps to provide your camera with permission to use precise locations for the Camera and Google as follows:

9) Return to the home screen by touching the tiny circle at the very bottom middle of the screen as shown below (the tiny circle has a heavy red circle around it):



10) Repeat steps 1-4 (touch **settings**, touch **search settings** bar, key in **Loc** and touch **Location Location**. Then for all but the Google Pixel phone, touch **App Location Permission**.

11) **Fig 9** will appear below left. Note that Camera is in the “**Not Allowed**” category. You will need to scroll down to find it. Touch **Camera** (circled in red).

12) **Fig 10 – Location Permission Camera** Screen will appear. Touch either of the dots that have a blue box around them – “Allow only while using the app or Ask every time.

13) **Fig 11a** will appear – note the **Use Precise Location** box has appeared and it is off. Slide

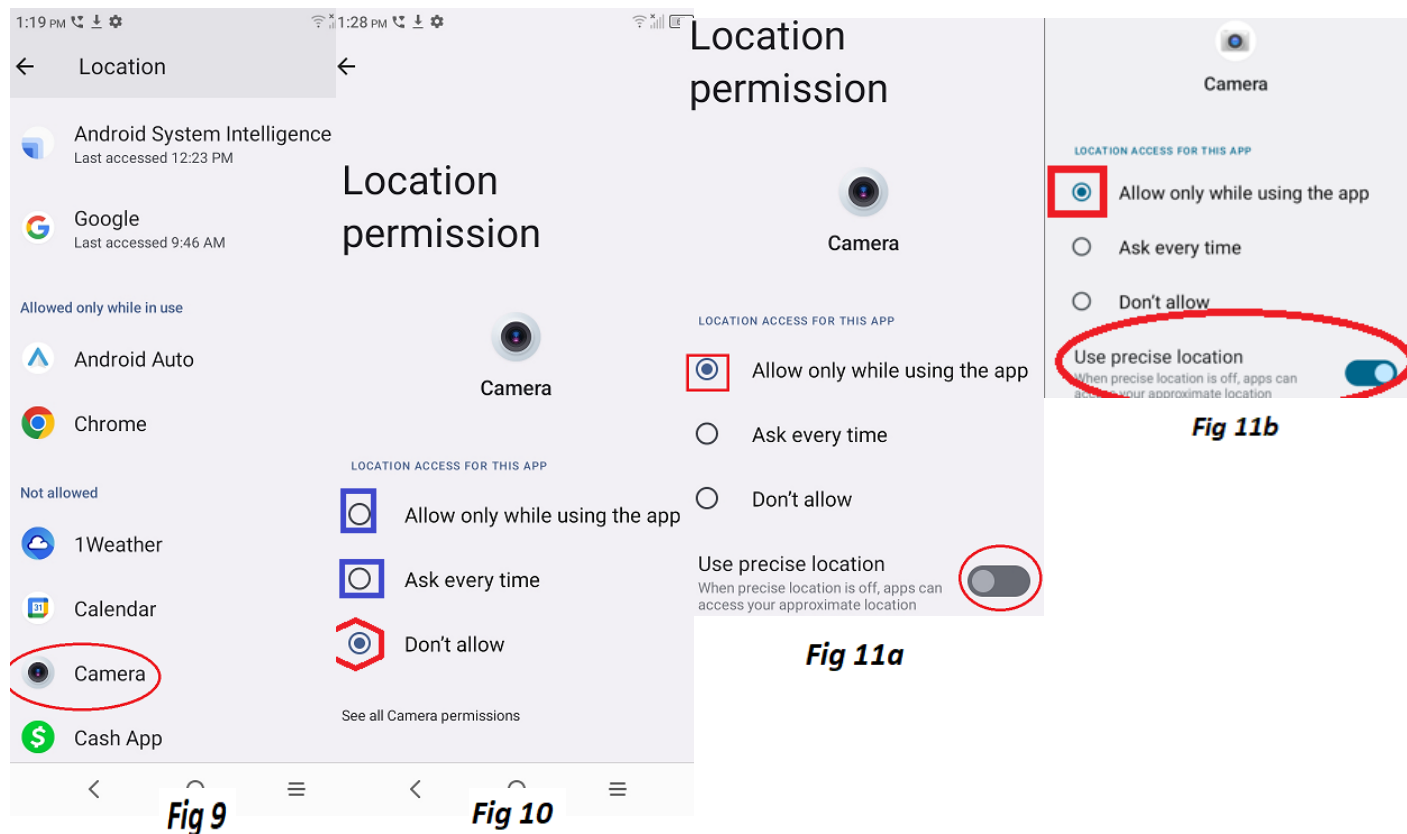

the circle to the right (circled in red) and Fig 11b will appear. Circle is now all the way right.

14) Return to the home screen by touching the tiny circle at the very bottom middle of the screen as shown below (the tiny circle has a heavy red circle around it):



15) Repeat steps 1-4 (touch **settings**, touch **search settings** bar, key in **Loc** and touch **Location** **Location**. Then for all but the Google Pixel phone, touch **App Location Permission**.

16) Locate **Google** – it should be in the first - **Allowed All the time** – category (see **Fig 6**, above). **Touch Google**. **Touch Allowed all the time** if it was not active (see **Fig 12** – area in red box) and verify that **Use precise location** is activated as shown in **Fig 12** (circled in red).

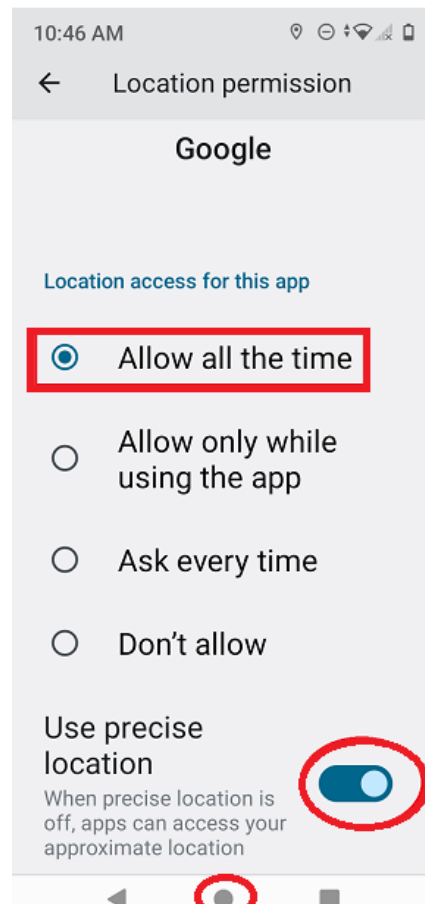

Fig 12

17. Geo Location setup is complete - Return to the home screen by touching the tiny circle at the very bottom middle of the screen as shown in **Fig 12** (the tiny circle has a heavy red circle around it):

IMPORTANT - Make sure Use Precise Locations is on for Chrome, Camera and Google and that Google is set to Allow all the time.