

SETUP LOCATION SERVICES - iPhone

Since the Heater Activity Report cannot be submitted unless **Precise Location Service** is activated, it is best to verify that it is on for both Safari (web browser) and the Camera. Factory default settings, however, typically do have Precise Location Services turned on. Heres how to verify.

1. Touch the Settings icon (it looks like a cog wheel on your home screen):



2. Touch the search box at the top of the screen - **Fig 1** below. The box is highlighted with a red arrow. Your virtual keyboard will appear. **Note:** Sometimes the Search box is hidden. If you don't see it, pull the screen down by simultaneously touching the grey circle (in this case it reads MC) and then gently swiping the screen down.

3) Key in **Privacy & Security**. **Fig 2** (below middle) will appear. Touch the **Location Services Bar** (top/circled in orange).

4) **Fig 3** (below right) will appear. Slide the circle in the Location Services bar (circled in orange) to the right (as indicated by the orange arrow) if the circle is positioned as shown in **Fig 3**

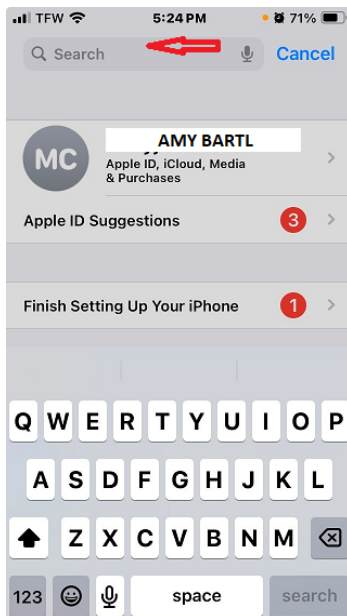

Fig 1

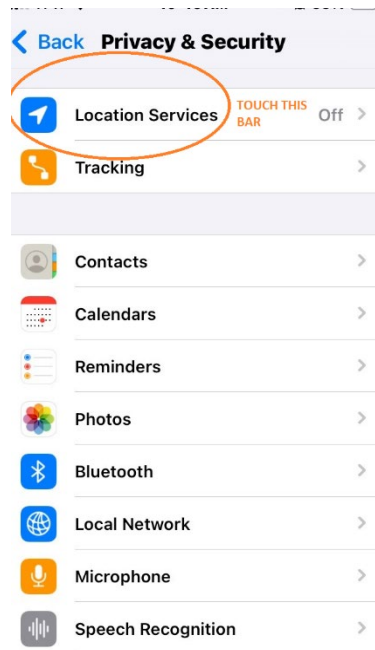

Fig 2

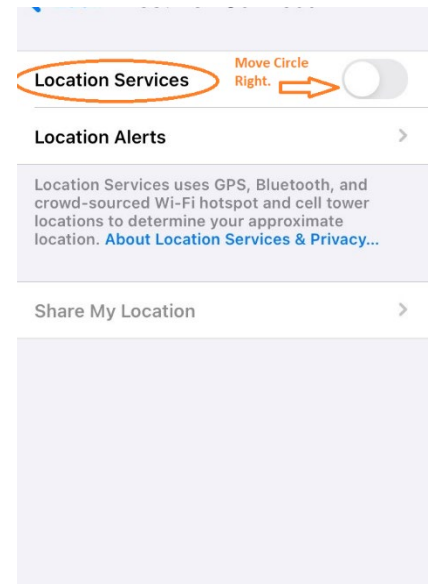

Fig 3

5) **Fig 4** (below, left) shows that **Location Services** are turned on. Note the area circled in red - the circle has moved and the empty space is green rather than gray. You now need to authorize specific Apps to share the program and authorize the communication of the **Precise Location**. There are two that you will need to authorize – **Camera and Safari**. Touch the screen on **Camera** (circled in blue in **Fig 4**, below left) .

6) The **Camera** screen (**Fig 5** – below middle left)) will appear – select by touching either “**While Using**

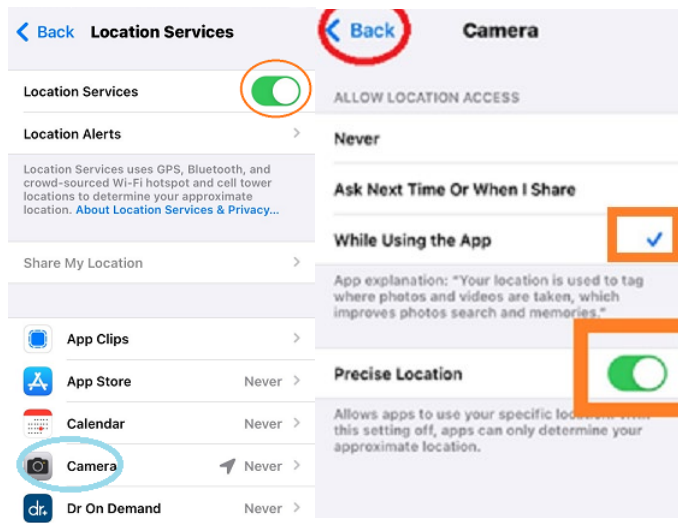

Fig 4

Fig 5

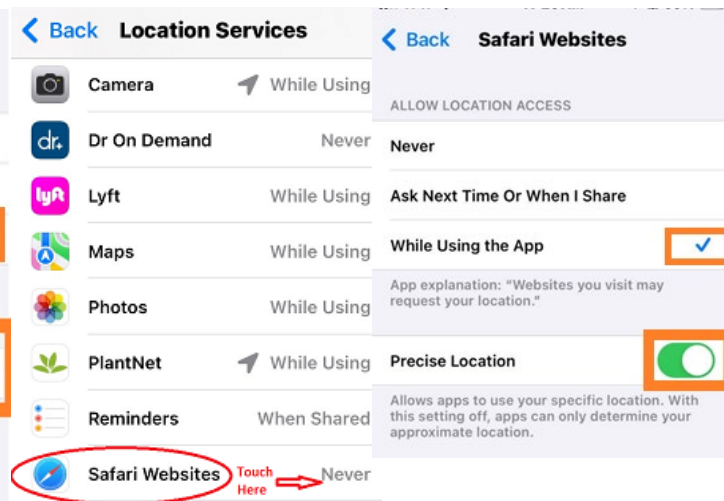

Fig 6

Fig 7

the App” (that will put precise geo location data on any picture you take) or “**Ask Next Time OR When I Share.**” If you select the latter, you will need to answer Yes or No to providing location each time you take a picture. In this case, the user has opted to provide the information on each picture taken as noted by the blue checkmark (inside the orange box).

IMPORTANT: Make Sure Precise Location is activated - If the ball is not all the way to the right (as shown in Fig 5 (above middle left) inside the second orange box), slide the ball to the right.

6) Touch the **back** button (circled in red in **Fig 5** at the top left of screen) to return to the **Location Services** screen.

This time/ scroll down and touch **Safari**. Your screen will look (depending on the Apps in your phone) like **Fig 6** (above middle right).

7) Touch the **Safari Website** bar. **Fig 7** (above right) will appear. Again, touch either “**While Using the App**” (that will provide the site with precise location data) or “**Ask Next Time OR When I Share.**” If you select the latter, you will need to answer Yes or No to providing the location each time you visit a site that requests your location as opposed to once, only). In this case, the user did provide permission “**While Using the App**” as indicated by the blue check mark (there is an orange square drawn around it) by touching that bar. In either situation, you will be asked the first time you visit a site whether you wish to authorize the site to see your location. **Be sure to select Allowed for the payroll site.**

IMPORTANT: Make Sure Precise Location is activated for both the Camera and Safari Apps - If the ball is not all the way to the right (as shown in Fig 5 inside the second red box), slide the ball to the right.